



# SNYDER PLAZA



THE  
GOLDBERG  
GROUP

630 SENTRY PARKWAY, SUITE 300  
BLUE BELL, PA 19422  
610.260.9600  
GOLDBERGGROUP.COM

- 316,652 SF
- SNYDER AVE & SWANSON ST, PHILADELPHIA, PA
- BEN ALEXANDER 610.260.1445  
BALEXANDER@GOLDBERGGROUP.COM

# SITE PLAN

## TENANT ROSTER

1	Soap Box Laundry	6,035 SF
2	USPS	2,975 SF
3	Dollar Tree	6,375 SF
4	Avalon Flooring	20,215 SF
5	Uncle Oogie's	2,800 SF
6	Rite Aid	10,385 SF
7	Boston Market	2,400 SF
8	Snipes	4,400 SF
9	<b>AVAILABLE</b>	<b>2,880 SF</b>
10	<b>AVAILABLE</b>	<b>1,920 SF</b>
11	Subway	2,400 SF
12	Shaking Crab	2,885 SF
13	Nail Salon	1,520 SF
14	Hair Cuttery	1,600 SF
15	Miracle Ear	1,600 SF
16	Dunkin'	1,600 SF
17	Savers	23,800 SF
18	Target	124,500 SF
19	ACME	53,530 SF
20	Verizon	4,000 SF
21	Greene Garage	8,400 SF
22	Harbor Freight	14,240 SF
23	Chuck E. Cheese's	10,392 SF
24	IHOP	4,800 SF

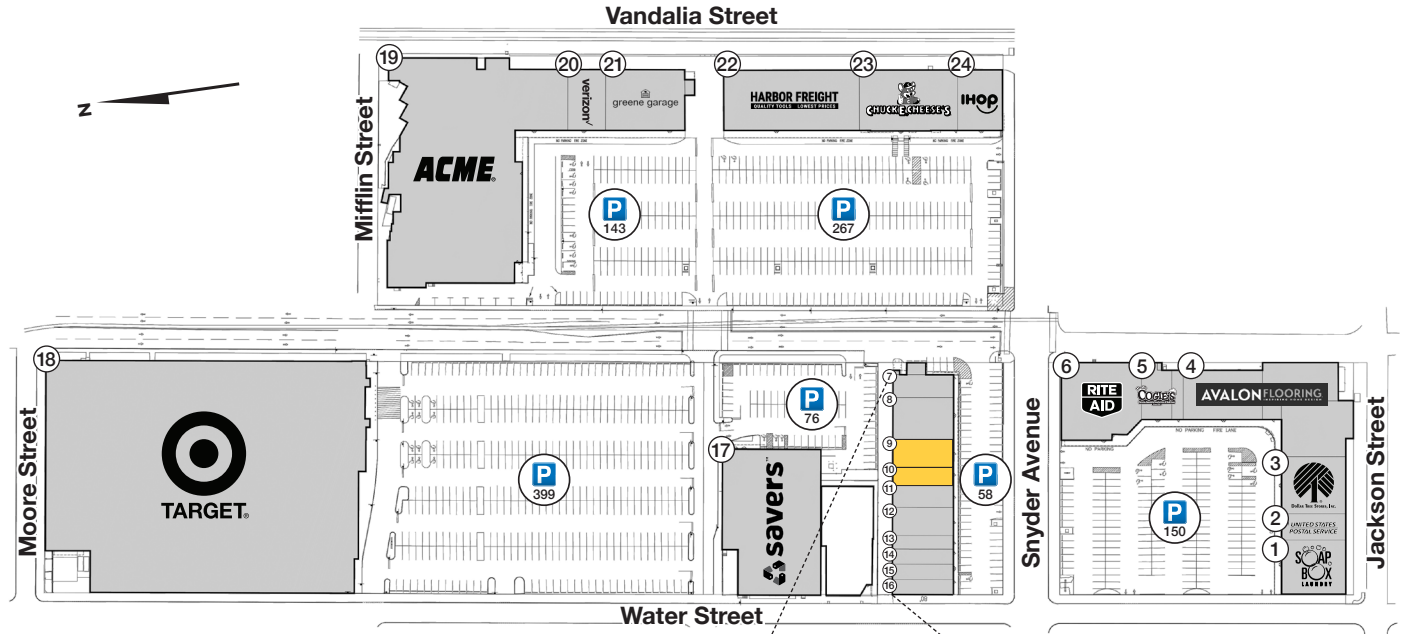

**AVAILABLE**  
2,880 SF

**AVAILABLE**  
1,920 SF

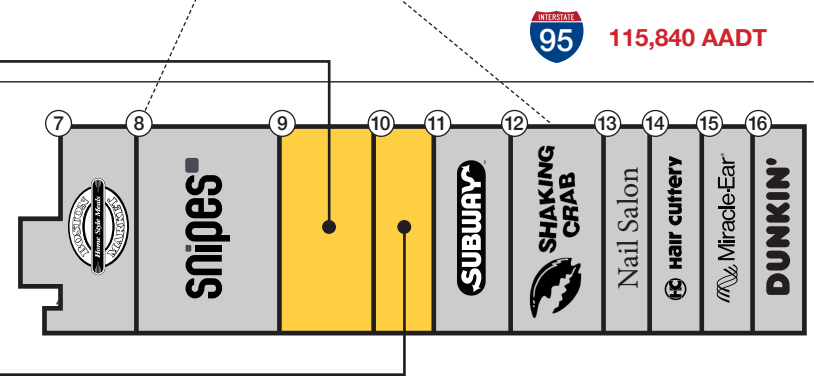

**115,840 AADT**

## DEMOGRAPHICS

**1 MILE**

- POPULATION: 49,982
- HOUSEHOLDS: 20,180
- AVG HH INCOME: \$75,908
- EMPLOYEES: 40,934

**3 MILES**

- POPULATION: 311,632
- HOUSEHOLDS: 146,263
- AVG HH INCOME: \$90,493
- EMPLOYEES: 259,431

**5 MILES**

- POPULATION: 758,461
- HOUSEHOLDS: 323,358
- AVG HH INCOME: \$75,143
- EMPLOYEES: 621,711

\*Estimate - Copyright 2020 Sites USA

# MARKET AERIAL



**SNYDER PLAZA**

- ACME
- hair cutters
- ihop
- verizon
- target
- snipes
- rite aid
- harbor freight
- Miracle-Ear
- Nail Salon
- avalon flooring
- greene garage
- subway
- united states postal service
- colex
- Diner at the Plaza
- savers
- dunkin'

- Bank of America
- beer
- BOB
- Chick-fil-A
- five BELOW
- ikea
- LONGHORN
- LOWES
- MILLER'S ALL-HOUSE
- MOORE'S
- Pier Imports
- Raymour & Flanigan
- SLEEPYS
- Visionworks
- YOUNG & RUBICAM

- Durldington
- DUNKIN'
- GNC
- Parry City
- Pauls
- ROSS
- Signature

- rite aid
- Save

- toysrus

