



SNYDER PLAZA



THE
GOLDBERG
GROUP

630 SENTRY PARKWAY, SUITE 300
BLUE BELL, PA 19422
610.260.9600
GOLDBERGGROUP.COM

- 316,652 SF
- SNYDER AVE & COLUMBUS BLVD. AT I-95, PHILADELPHIA, PA
- BEN ALEXANDER 610.260.1445
BALEXANDER@GOLDBERGGROUP.COM

SITE PLAN

TENANT ROSTER

1	Soap Box Laundry	6,035 SF
2	USPS	2,975 SF
3	Dollar Tree	6,375 SF
4	Avalon Flooring	20,215 SF
5	Uncle Oogie's	2,800 SF
6	Rite Aid	10,385 SF
7	Boston Market	2,400 SF
8	Snipes	4,400 SF
9	Kyoto Japanese Restaurant	3,880 SF
10	AVAILABLE	1,920 SF
11	Subway	2,400 SF
12	Shaking Crab	2,885 SF
13	Nail Salon	1,520 SF
14	Hair Cuttery	1,600 SF
15	Miracle Ear	1,600 SF
16	Dunkin'	1,600 SF
17	Marshall's	23,800 SF
18	Target	124,500 SF
19	ACME	53,530 SF
20	Verizon	4,000 SF
21	Greene Garage	8,400 SF
22	Harbor Freight	14,240 SF
23	Chuck E. Cheese's	10,392 SF
24	IHOP	4,800 SF

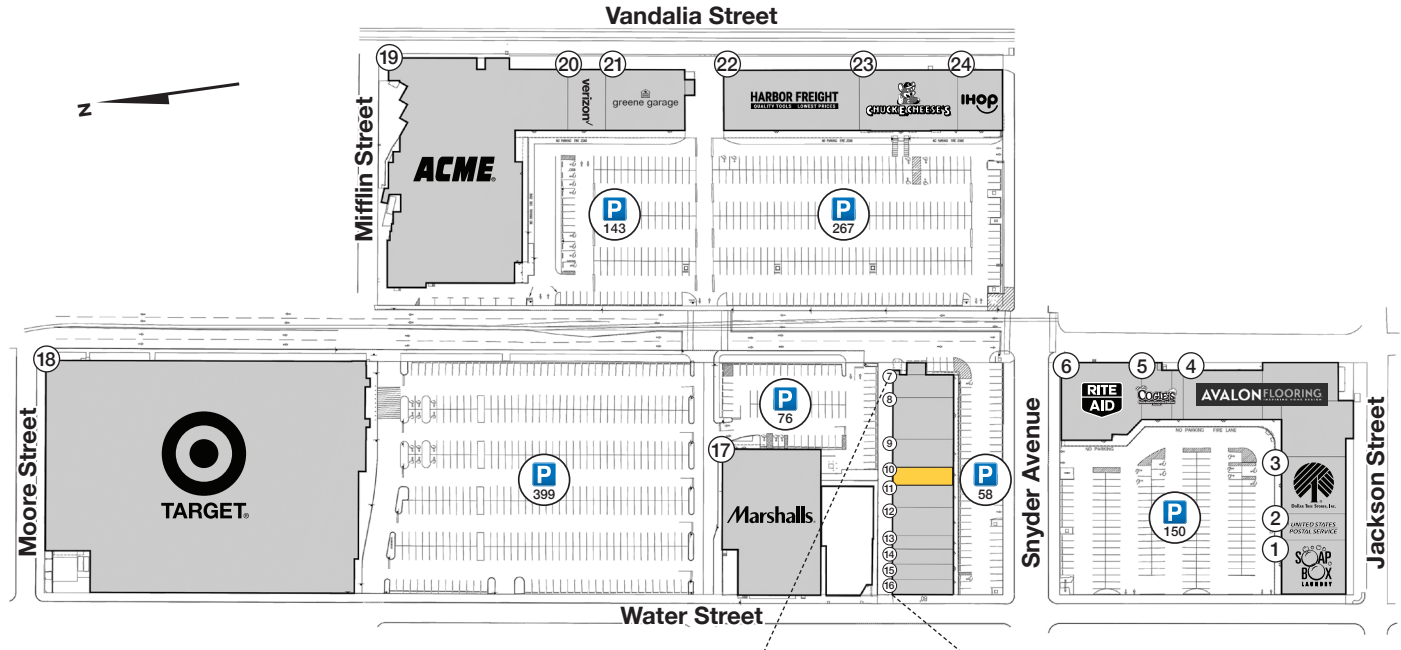

95 115,840 AADT

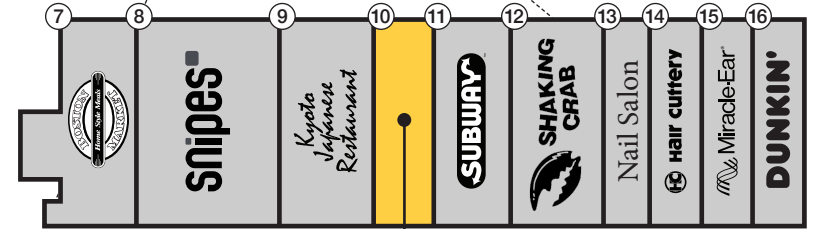

AVAILABLE
1,920 SF

DEMOGRAPHICS

1 MILE

- POPULATION 49,982
- HOUSEHOLDS 20,180
- AVG HH INCOME \$75,908
- EMPLOYEES 40,934

3 MILES

- POPULATION 311,632
- HOUSEHOLDS 146,263
- AVG HH INCOME \$90,493
- EMPLOYEES 259,431

5 MILES

- POPULATION 758,461
- HOUSEHOLDS 323,358
- AVG HH INCOME \$75,143
- EMPLOYEES 621,711

*Estimate - Copyright 2020 Sites USA

MARKET AERIAL



SNYDER PLAZA

- ACME
- hair cuttery
- ihop
- verizon
- Target
- Kyoto Japanese Restaurant
- Marshalls
- RITE AID
- HARBOR FREIGHT
- Snyder Beverage
- Miracle-Ear
- Nail Salon
- AVALON FLOORING
- greene garage
- SUBWAY
- UNITED STATES POSTAL SERVICE
- Diner at the Plaza
- DUNKIN'
- snipes

- Bank of America
- BEER
- BOB
- Chick-fil-A
- five BELOW
- IKEA
- LONGHORN
- LOWE'S
- MILLER'S ALL-HOUSE
- MOORE'S
- Pier Imports
- Raymour & Flanigan
- SLEEPYS
- Visionworks
- YOUNG

- Durldington
- BONNITS
- GNC
- Perry City
- Pauleless
- ROSS
- TOYS R US

- RITE AID
- Save

- AC MOORE
- Famous Footwear
- OLD NAVY

- Walmart

